



HEATING CABLES



HEATING CABLES

ACCESSORIES

HEATING PANELS

FIREPLACES

HEATERS

HEATING CABLES

THERMOSTATS

HEATING MATS

HEATING FOILS

HEATING CABLES TF-KGJZ

Storage heating - warmth and protection against cold



Heating cables cast in the screed layer, also called accumulation floor systems, are characterized by high thermal inertia. This means that the floor heats up slowly and releases heat equally slowly. Thanks to this, we can use inexpensive electricity available in cheaper energy tariffs of a given country.

Termofol **TF-KGJZ** heating cables are an accumulation system that can be the basic source of heat for rooms and buildings. They can also support an existing heating system.



1. Coating made of heat-resistant PVC 2. Screen - braided tin-plated copper wires
3. PVC insulation 4. XLPE insulation 5. Multi-wire heating conductor

25-YEAR

WARRANTY
ON TF-KGJZ

▼ Specification

■ Termofol TF-KGJZ v. 10W/m

Model	Length [m]	Diameter [mm]	Power [W/m]	Cable power [W]	Voltage [V]
TF-KGJZ 100/10	10	4.8-5.6	10	100	AC230
TF-KGJZ 150/10	15	4.8-5.6	10	150	AC230
TF-KGJZ 200/10	20	4.8-5.6	10	200	AC230
TF-KGJZ 250/10	25	4.8-5.6	10	250	AC230
TF-KGJZ 300/10	30	4.8-5.6	10	300	AC230
TF-KGJZ 350/10	35	4.8-5.6	10	350	AC230
TF-KGJZ 400/10	40	4.8-5.6	10	400	AC230
TF-KGJZ 450/10	45	4.8-5.6	10	450	AC230
TF-KGJZ 500/10	50	4.8-5.6	10	500	AC230
TF-KGJZ 600/10	60	4.8-5.6	10	600	AC230
TF-KGJZ 700/10	70	4.8-5.6	10	700	AC230
TF-KGJZ 800/10	80	4.8-5.6	10	800	AC230
TF-KGJZ 900/10	90	4.8-5.6	10	900	AC230
TF-KGJZ 1000/10	100	4.8-5.6	10	1000	AC230
TF-KGJZ 1200/10	120	4.8-5.6	10	1200	AC230
TF-KGJZ 1400/10	140	4.8-5.6	10	1400	AC230
TF-KGJZ 1600/10	160	4.8-5.6	10	1600	AC230
TF-KGJZ 2000/10	200	4.8-5.6	10	2000	AC230

■ Termofol TF-KGJZ v. 20W/m

Model	Length [m]	Diameter [mm]	Power [W/m]	Cable power [W]	Voltage [V]
TF-KGJZ 150/20	7,5	4.8-5.6	20	150	AC230
TF-KGJZ 200/20	10	4.8-5.6	20	200	AC230
TF-KGJZ 300/20	15	4.8-5.6	20	300	AC230
TF-KGJZ 400/20	20	4.8-5.6	20	400	AC230
TF-KGJZ 500/20	25	4.8-5.6	20	500	AC230
TF-KGJZ 600/20	30	4.8-5.6	20	600	AC230
TF-KGJZ 700/20	35	4.8-5.6	20	700	AC230
TF-KGJZ 850/20	42,5	4.8-5.6	20	850	AC230
TF-KGJZ 1000/20	50	4.8-5.6	20	1000	AC230
TF-KGJZ 1200/20	60	4.8-5.6	20	1200	AC230
TF-KGJZ 1400/20	70	4.8-5.6	20	1400	AC230
TF-KGJZ 1600/20	80	4.8-5.6	20	1600	AC230
TF-KGJZ 1800/20	90	4.8-5.6	20	1800	AC230
TF-KGJZ 2000/20	100	4.8-5.6	20	2000	AC230
TF-KGJZ 2200/20	110	4.8-5.6	20	2200	AC230
TF-KGJZ 2400/20	120	4.8-5.6	20	2400	AC230
TF-KGJZ 2600/20	130	4.8-5.6	20	2600	AC230
TF-KGJZ 2800/20	140	4.8-5.6	20	2800	AC230
TF-KGJZ 3100/20	155	4.8-5.6	20	3100	AC230V



TF-OHMAT HEATING MAT



Dry driveway all year round

TF-OHMAT heating mats are intended for outdoor use and constitute an advanced anti-icing system. Their main use is to heat sidewalks and driveways to prevent snow and ice from accumulating. Choosing the right heating mats eliminates the need to clear snow and ensures that the surface is kept dry. Outdoor heating mats also provide safety because they eliminate the risk of slipping.

TF-OHMAT mats are powered by 230V and can be installed directly under paving surfaces, paving tiles or concrete screeds. They are available in powers from 300 to even 4800 watts and in lengths from 2 to 32 meters.

1. Heat-resistant PVC coating 2. Aluminum foil 3. XLPE insulation 4. Multi-wire heating wire

10-YEAR

**WARRANTY
ON TF-OHMAT**

■ The TF-OHMAT heating mat is ideal to driveways.

▼ Specification

Model	Area [m ²]	Length [m]	Diameter [mm]	Power [W/m ²]	Mat power [W]	Voltage [V]
TF-OHMAT/300/300/1.0	1	2	6.0-6.5	300	300	AC230
TF-OHMAT/300/450/1.5	1.5	3	6.0-6.5	300	450	AC230
TF-OHMAT/300/600/2.0	2	4	6.0-6.5	300	600	AC230
TF-OHMAT/300/900/3.0	3	6	6.0-6.5	300	900	AC230
TF-OHMAT/300/1200/4.0	4	8	6.0-6.5	300	1200	AC230
TF-OHMAT/300/1500/5.0	5	10	6.0-6.5	300	1500	AC230
TF-OHMAT/300/1800/6.0	6	12	6.0-6.5	300	1800	AC230
TF-OHMAT/300/2100/7.0	7	14	6.0-6.5	300	2100	AC230
TF-OHMAT/300/2400/8.0	8	16	6.0-6.5	300	2400	AC230
TF-OHMAT/300/3000/10.0	10	20	6.0-6.5	300	3000	AC230
TF-OHMAT/300/3600/12.0	12	24	6.0-6.5	300	3600	AC230
TF-OHMAT/300/4200/14.0	14	28	6.0-6.5	300	4200	AC230
TF-OHMAT/300/4800/16.0	16	32	6.0-6.5	300	4800	AC230



■ Forget about icy stairs.

HEATING FOILS

HEATING MATS

THERMOSTATS

HEATING CABLES

HEATERS

FIREPLACES

HEATING PANELS

ACCESSORIES

HEATING CABLE TF-KZT



Where can heating cables be used?

The basic task of heating cables is to maintain a positive temperature in the pipes. In home conditions, it most often involves a water installation outside the building, e.g. supplying water to a garden or another building in the household. This is where the greatest risk of water freezing and, as a result, pipe failure occurs.

▼ TF-KZT integrated with the thermostat

Termofol TF-KZT is a heating cable that protects pipes and valves against freezing in the harshest winter. With the Termofol TF-KZT protection system, you do not have to worry about water pipes or valves in unheated rooms and outside the building. Installation of the system is quick and simple, and the cable itself is mounted on the pipe. The operation of the system does not require control because the heating cable is equipped with a thermostat. The heating cable is intended for installation on pipelines and tanks protected by 10 mm thick thermal insulation. It does not require the installation of a separate control, as in the case of traditional heating cables. It works very well in residential and recreational facilities.



1. Coating made of heat-resistant PVC 2. Screen – braid made of tinned copper wires
3. Aluminum foil 4. XLPE insulation 5. Multi-wire heating wire



- Example of installation of the TF-KZT cable on pipelines protected by insulation.

Model	Length [m]	Cable power [W]	Voltage [V]
TF-KZT-30-2	2	30	AC230
TF-KZT-60-4	4	60	AC230
TF-KZT-75-5	5	75	AC230
TF-KZT-90-6	6	90	AC230
TF-KZT-120-8	8	120	AC230
TF-KZT-150-10	10	150	AC230
TF-KZT-180-12	12	180	AC230
TF-KZT-210-14	14	210	AC230
TF-KZT-225-15	15	225	AC230
TF-KZT-270-18	18	270	AC230
TF-KZT-300-20	20	300	AC230
TF-KZT-360-24	24	360	AC230
TF-KZT-375-25	25	375	AC230

HEATING CABLE TF-CW-SR

▼ Anti-freeze TF-CW-SR, self-regulating

TF-CW-SR heating cables are designed to prevent water from freezing in pipes and pipelines up to 2 inches in diameter. Thanks to the use of self-regulation, there is no need to use a thermostat. When the outside temperature drops significantly, the cables heat more often and more intensely, but during light frosts they work sporadically.

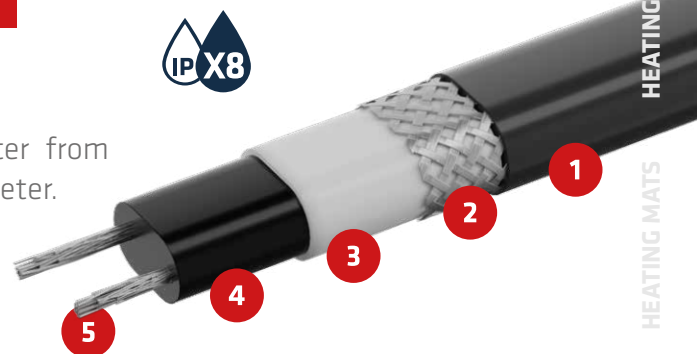

1. Coating made of heat-resistant PVC
4. Self-regulating semiconductor core

2. Screen - braid made of tinned copper wires
5. Multi-wire tinned copper heating wire 20A

3. Insulation made of thermoplastic elastomer



▼ Advantages

- Installation inside the pipe
- Ready to connect
- Effective anti-freeze protection
- Safe use
- Low installation and operating costs
- The system does not require maintenance

Model	Length [m]	Diameter [mm]	Power [W/m]	Cable power [W]	Voltage [V]
TF-CW-SR 1m	1	8.0×5.1	10	10	AC230
TF-CW-SR 2m	2	8.0×5.1	10	20	AC230
TF-CW-SR 4m	4	8.0×5.1	10	40	AC230
TF-CW-SR 6m	6	8.0×5.1	10	60	AC230
TF-CW-SR 8m	8	8.0×5.1	10	80	AC230
TF-CW-SR 10m	10	8.0×5.1	10	100	AC230
TF-CW-SR 12m	12	8.0×5.1	10	120	AC230
TF-CW-SR 14m	14	8.0×5.1	10	140	AC230
TF-CW-SR 16m	16	8.0×5.1	10	160	AC230
TF-CW-SR 18m	18	8.0×5.1	10	180	AC230
TF-CW-SR 20m	20	8.0×5.1	10	200	AC230
TF-CW-SR 25m	25	8.0×5.1	10	250	AC230
TF-CW-SR 35m	35	8.0×5.1	10	350	AC230



HEATING CABLE TF-KGSR



▼ TF-KGSR self-regulating cable

Termofol TF-KGSR is a self-regulating (variable resistance) cable intended for installation in external anti-icing and antifreeze systems of buildings.

Thanks to the power self-regulation technology, these cables can be used to protect roofs and gutters and pipes, drainage channels, pipelines, as well as structural elements of machines and devices. Anti-icing heating cables are an excellent way to get rid of ice and frozen snow in gutters, downspouts and roof slopes directly above the gutter.

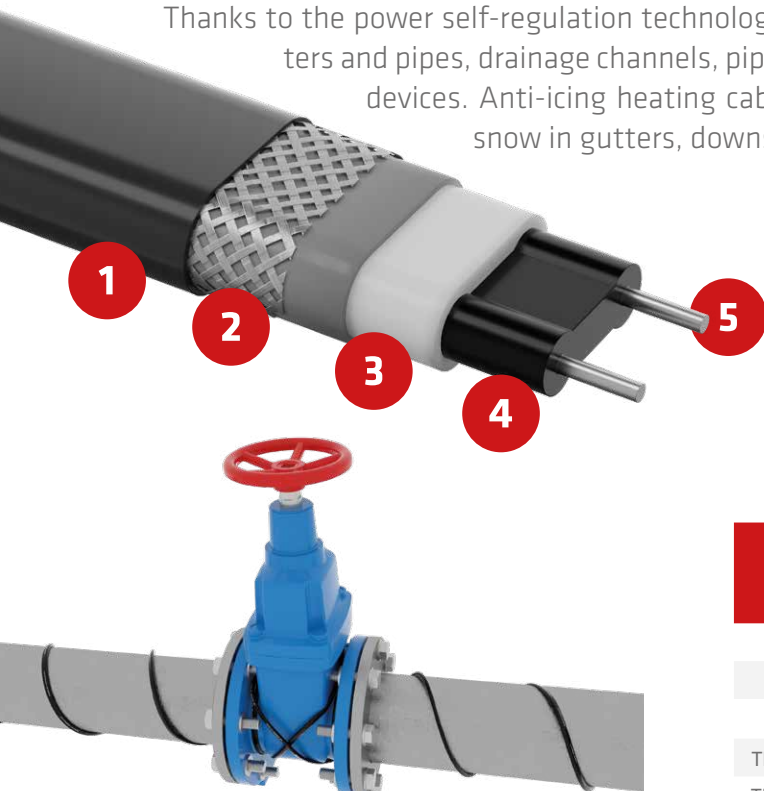

1. Heat-resistant PVC coating
2. Screen – braid of tinned copper wires
3. Thermoplastic elastomer insulation
4. Self-regulating semiconductor core
5. Multi-wire tinned copper heating wire 20A

Model	Dimensions [mm]	Cable power [W]	UV resistance	Voltage [V]
TF-KGSR-10-2CR	11.0x6.2	10	no	AC230
TF-KGSR-16-2CR	11.0x6.2	16	no	AC230
TF-KGSR-24-2CR	11.0x6.2	24	no	AC230
TF-KGSR-30-2CR (UV)	11.0x6.2	30	yes	AC230
TF-KGSR-40-2CR (UV)	11.0x6.2	40	yes	AC230

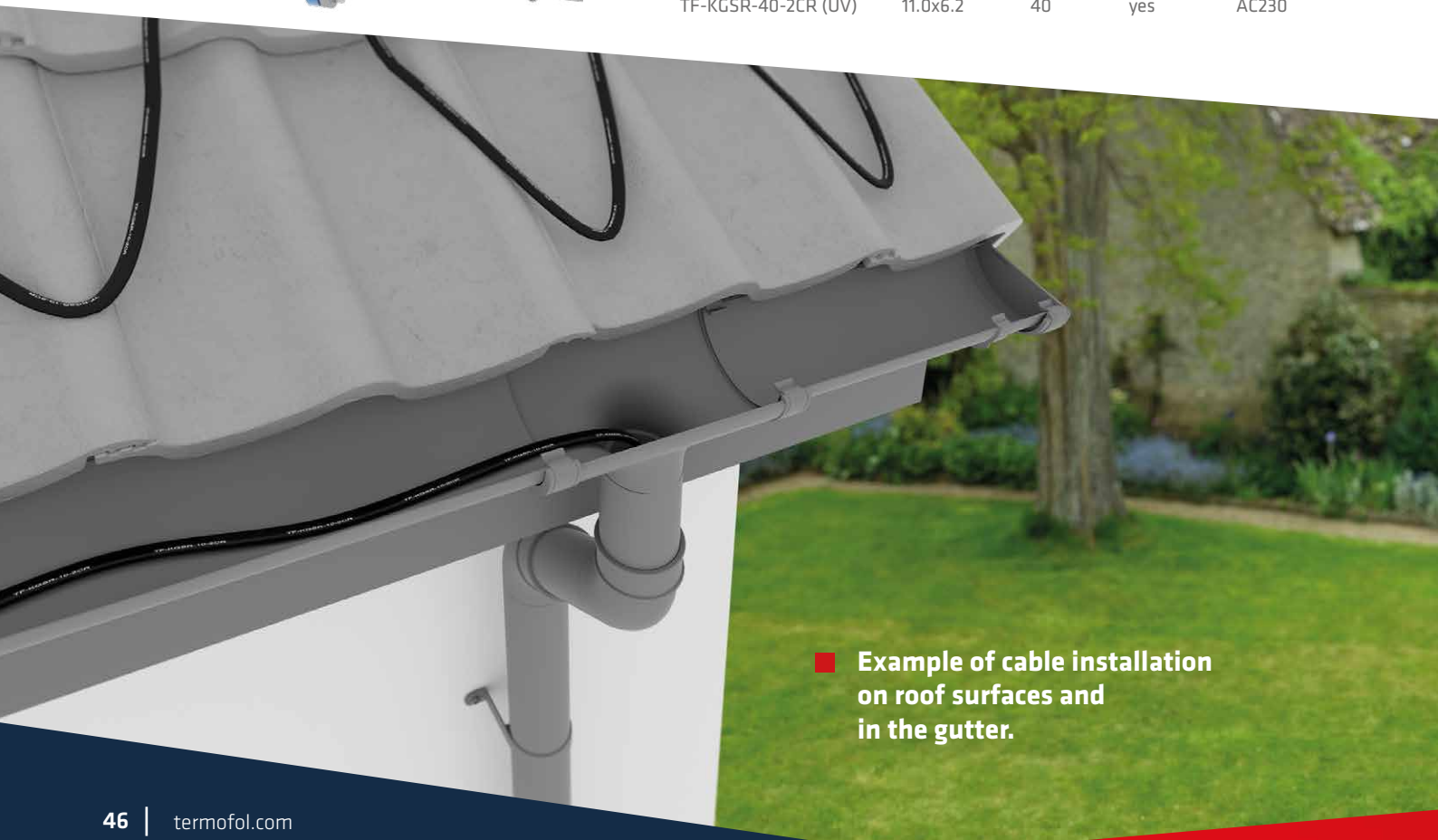

■ **Example of cable installation on roof surfaces and in the gutter.**

CONTROLLERS

Thermoregulator TF-M1



The TF-M1 thermoregulator is a device designed to control electric heating systems used to prevent the formation of ice and snow. It allows you to control one anti-icing zone. The device is operated manually using knobs. It is mounted on a DIN rail and status information is indicated by diodes.



Specification: Voltage: 230V, 50-60Hz • output relay (potential contact, NO): 16 A • Hysteresis: 0.3K • temperature regulation range: from 0 °C to +10 degrees C • tightness of the controller housing: IP 20 • clock: switch-off delay setting from 0 to 5 hours • weight: 200g • dimensions: height 86, width 52, depth 59 mm

Thermoregulator TF-M2



The TF-M2 thermoregulator is a device for controlling heating systems that prevent ice from forming in gutters, pipes, driveways, roofs and stairs. It allows you to control two zones with the settings displayed on the LCD screen. Manually operated with a knob.



Specification: Voltage: 120/230V, 50-60Hz • built-in transformer: 24 VAC, 6 VA • three output relays (potential-free contact): 3x16 A • one auxiliary relay (potential-free contact): 5A • hysteresis: 0.3K • adjustment range temperatures: from 0 degrees C to +5 degrees C • weight: 600g • dimensions: height 90, width 156, depth 45 mm • tightness of the controller housing for surface mounting: IP 21

■ Our anti-icing heating cables were installed on Park & Ride ramps on Górka Narodowa in Cracow.

